

# GAST/JUN-AIR

GAST MFG, INC. & JUN-AIR  
 A Unit of IDEX Corporation  
 Post Office Box 97  
 Benton Harbor, Michigan 49022 U.S.A.  
 Ph: 269/926-6171  
 Fax: 269/925-8288

**PART NUMBER: RTD1080**

**REVISION: A**

## PRODUCT SPECIFICATIONS

MODEL NO.	MOTOR	RPM		AMPS		HP	KW	NET WT.		CAPACITOR	
		60HZ	50HZ	60HZ	50HZ			lbs.	kg	mfd.	VOLT
87R642-PS103R-N470X	115-120/230-240 (60Hz) 110-120/220-240 (50Hz)	1725	1425	5.7/2.8	5.1/2.6	1/2	0.37	19.1	8.6	30	370

**SOUND LEVEL** LESS THAN 60 db(A)

**NORMAL AMBIENT** +5 °C - +40 °C

**RELATIVE HUMIDITY** 20% - 80%

**ENVIRONMENT** CLEAN DUST FREE

**NOTES:**

1. TECHNICAL DATA SUBJECT TO CHANGE WITHOUT NOTICE.
2. THIS PUMP MUST BE INSTALLED IN AN ENCLOSURE.
3. ALL DIMENSIONS ARE FOR REFERENCE ONLY.
4. KIT P/N: K965
5. THIS MODEL HAS A BIASED VALVE TO AID RESTART.
6. THIS UNIT UTILIZES SOUND SHIELD (SSP-87R6-02), WHICH HAS A RECOMMENDED SERVICE INTERVAL OF 2,000 HOURS OR 2 YEARS.

## PRODUCT PERFORMANCE:

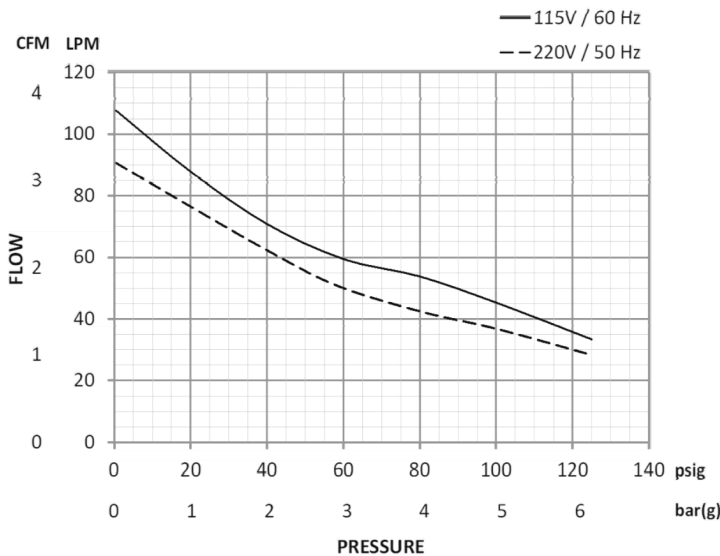

## PRODUCT DIMENSIONS:

**WIRING DIAGRAM**

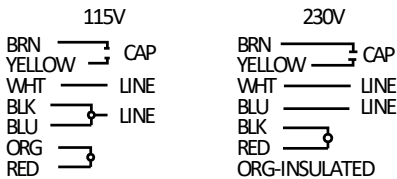

CAPACITOR MOUNTING KIT TO BE SHIPPED UNATTACHED.

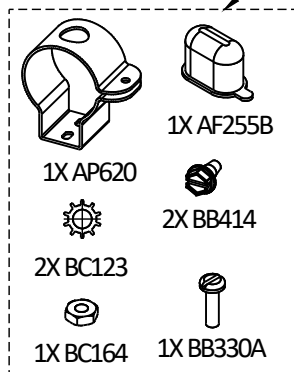

CAPACITOR TO BE SHIPPED UNATTACHED

